

RO

Hot Melt Jetting Heads SX Diamond / SX LongLife

durable | precise | flexible



SX Diamond / SX LongLife

For Durable and Precise Adhesive Application

The insulated jetting heads of the **SX Diamond** series are ideally suited for non-contact application of low- to medium-viscosity hot melt adhesives. The **SX Diamond** and **SX LongLife** are identical and only differ in the jetting element. They can be flexibly used thanks to their small installation dimensions.

Durable, reliable, and precise

The specially developed jetting elements and the robust solenoid valve make the application heads particularly durable. Using the solenoid valve, the double-acting, electro-pneumatic jetting head achieves a precise and consistent adhesive application with clean cut-off. Thanks to the filter integrated in the heating block, nozzle blockage is prevented. Nozzle damage as well as heat loss are minimized through nozzle protection. This results in an even better cut-off behavior and reduced operation interruptions.

Increased safety and sustainability

With CoolTouch insulation, the Diamond series increases operational safety. The jetting head insulation protects operators as well as products to be glued from heat. The heat-resistant insulation reduces energy consumption and ensures a constant adhesive temperature, even with a draft from very fast running machines.

Modularity and compatibility

Thanks to the modular design, the application heads can be used in a variety of different design versions with selectable jetting elements and valve heads. This enables us to meet customer-specific production needs precisely. As part of the Diamond series, they are compatible with most Robatech application systems. This simplifies integration into existing machines and reduces spare part costs.

Your advantages

- Cost-efficient thanks to durability with 50 resp. 200 million operating cycles
- Precise adhesive application with clean cut-off even at high speed
- Flexible thanks to modular design
- Energy-efficient and safe thanks to CoolTouch insulation
- No nozzle blockages thanks to integrated filter
- Constant temperature for highest adhesive quality
- Optional bottom-up protection for applications from bottom to top

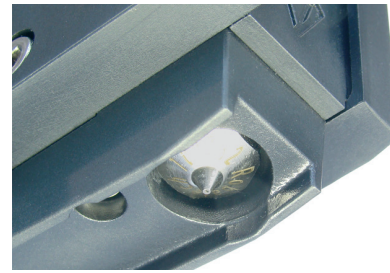

Technical data

	SX Diamond	SX LongLife
Temperature range	20 to 200 °C	
Adhesive pressure	Max 75 bar	
Adhesive	Thermoplastic adhesives	
Adhesive viscosity	500 to 5,000 mPas	
Operating cycles	50 million*	200 million* (296 / KV) 100 million* (NV)
Switching frequency	120 Hz*/**	
Adhesive outlet	5 ms*	
Jetting element width	18 mm	
Nozzles	296 / 294	296 / 294 / KV / NV / NV long
Air connection	6 bar, cleaned and not oiled	
Supply voltage	230 VAC (EN60204), 50/60 Hz	
Supply voltage, solenoid valve	24 VDC / 8 W	
Attachment	For shaft ø 12mm, flat steel or M5 thread	
Noise level	Approx. 65 to 70 dB(A)	
Degree of protection	IP42 (IP55 as option)	

* For jetting element and valve. Depending on operating environment and conditions (adhesive, temperature, frequency, etc.)

** Continuous load maximum 50 Hz.

Robatech AG, Headquarters
Pilatusring 10
CH-5630 Muri
Switzerland
Tel. +41 56 675 77 00
info@robatech.ch
www.robatech.com

Robatech
Gluing Technology